

SMARTOP

Vanish XLR

by Leisure Concepts

Installation Instructions - Updated as of 01/24/21

Figure 1

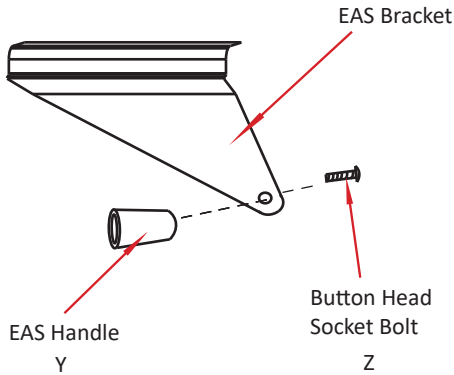

Step #1

Position the Smartop (in closed position) on the spa making sure that all four corners are properly positioned and square on the spa.

Step #2

Attach the EAS handle to the EAS bracket using the supplied 5/16 x 1-1/4" button head socket bolt (see Fig. 1).

Step #3

Attach the Vanish XL pivot arms to the Smartop using the supplied button head socket bolts and let the assembly hang freely (see Fig. 2). **Note: Make sure to run the bolts from the inside out. The locknuts need to be facing outwards. Also, make sure to use the supplied plastic washers as a spacer in between the metal plate on the pivot arms and the Vanish XL cover mounting bracket. Do not overtighten bolts, the pivot arms must rotate freely.**

Step #4

Swing the Vanish XL bracket assembly forward making sure the two pivot arms rest against each other (see Fig. 2). Attach the Vanish XL bracket assembly to the spa cabinet using the supplied #10 x 1-1/2" mounting screws. **Note: Make sure to put downward pressure on the Smartop when attaching the Vanish XL bracket assembly to the spa cabinet to ensure the Smartop is making a good seal with the acrylic of the spa.**

Figure 2

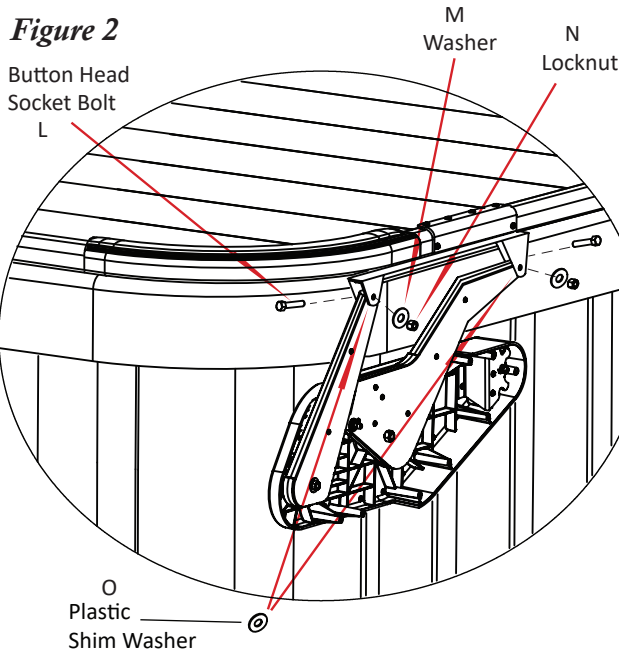

Step #5

Slide the Vanish XL filler back behind the Vanish XL base assembly until it is firmly seated between the spa and the Vanish XL base assembly. Attach the Vanish XL filler to the spa using the supplied #10 x 1" black self-tapping screws (see Fig. 3). Attach the Vanish XL base assembly to the Vanish XL filler using the supplied #10 x 1" black self-drilling screws (see Fig. 3).

Step #6

To attach the shocks to the bracket assembly, partially open your Smartop cover and snap the shocks onto the appropriate ball studs (see Fig. 4). **Note: Make sure the black body of the shock is pointing towards the middle of the Smartop.**

Figure 3

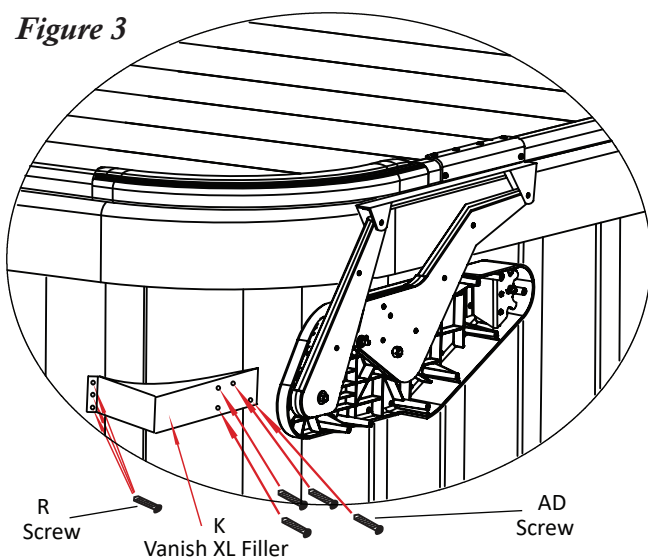

Figure 4

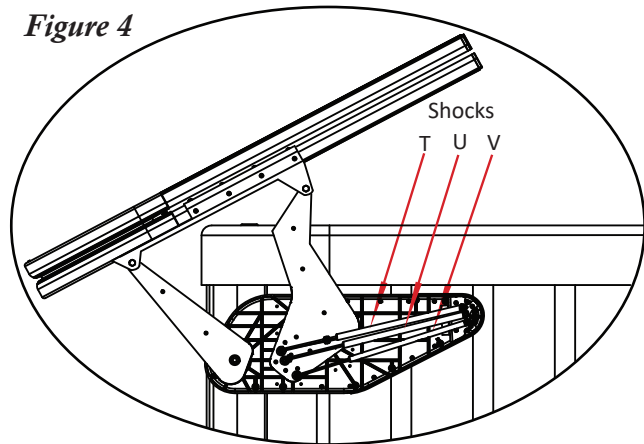
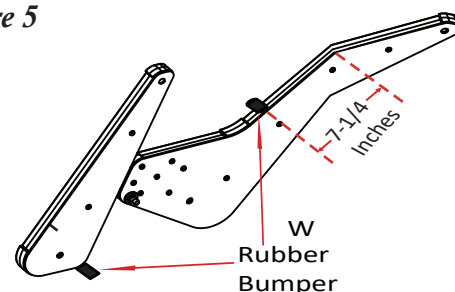

Figure 5



Step #7

Open the Smartop so it is in the fully upright position. Using the supplied #10 x 1-1/2" mounting screws, finish attaching the Vanish XL bracket assembly to the spa.

Step #8

Attach the rubber bumpers to the front and rear pivot arms using the supplied #8 x 1-1/4" flat head self-tapping screws (see Fig. 5).

Step #9

Attach the Vanish XL cover plate to the bracket assembly using the supplied #10 x 1" black self-tapping screws. Next, thread the 3/8 x 3/4" hex cap bolt through the hole in the cover plate that lines up with the rear pivot arm (see Fig. 6). **Note: Do not over-tighten hex cap bolt.**

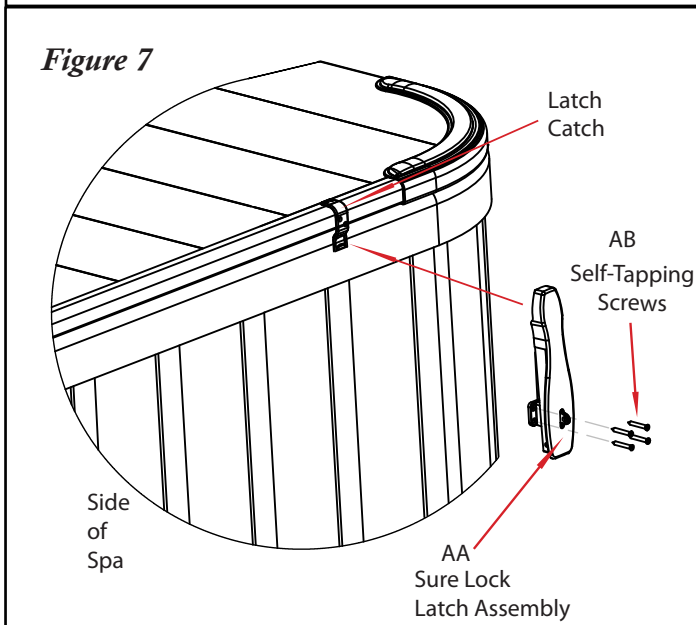
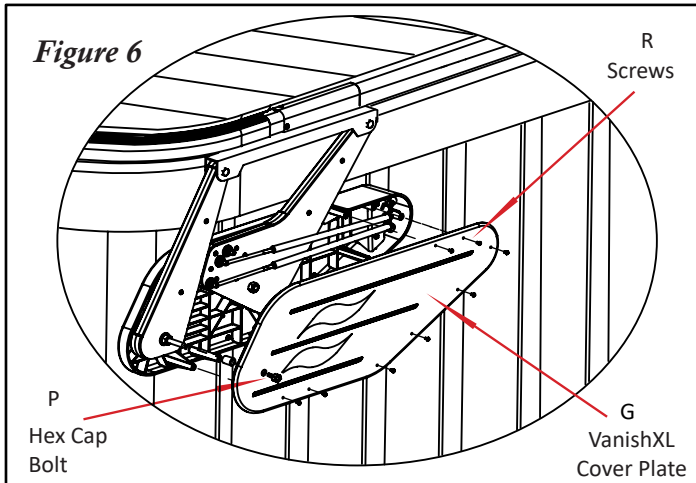

Step #10

Connect the Sure Lock latch to the latch catch. **While pushing down on the Smartop**, position the Sure Lock latch on the side of the spa and mark where the latch base rests against the spa skirting. Attach the Sure Lock latch to the spa skirting, where marked, using the supplied #8 x 3/4" self-tapping screws (see Fig. 7).

Operation of your Smartop Cover

- 1) Fold the first half of the Smartop cover off the spa. While gripping the EAS handle, motion the Smartop cover into it's vertical upright position.

ITEM	PART#	DESCRIPTION	QTY
A(L)	101733	VANISH XL BASE BRACKET (L)	1
A(R)	101734	VANISH XL BASE BRACKET (R)	1
B	101737	VANISH XLR/XLRP PIVOT ARM - FRONT	1
C	101738	VANISH XLR/XLRP PIVOT ARM - REAR	1
D(L)	101858	VANISH XLR/XLRP PIVOT ARM PLATE - FRONT - LEFT	1
D(R)	101859	VANISH XLR/XLRP PIVOT ARM PLATE - FRONT - RIGHT	1
E(L)	101856	VANISH XLR/XLRP PIVOT ARM PLATE - REAR - LEFT	1
E(R)	101857	VANISH XLR/XLRP PIVOT ARM PLATE - REAR - RIGHT	1
F(L)	101741	BALL STUD MOUNTING PLATE - LEFT	1
F(R)	101742	BALL STUD MOUNTING PLATE - RIGHT	1
G(L)	101743	VANISH XL COVER PLATE (L)	1
G(R)	101744	VANISH XL COVER PLATE (R)	1
H	101745	VANISH XL COVER PLATE ANCHOR	2
I	101746	LARGE PIVOT ARM SHIM	4
J	101747	SMALL PIVOT ARM SHIM	4
K(L)	100577	VANISH XLR FILLER (L)	1
K(R)	100578	VANISH XLR FILLER (R)	1
L	101749	3/8 X 2" BUTTON HEAD SOCKET BOLT - BLACK ZINC	4
M	100012	3/8 FLAT WASHER	4
N	100011	3/8 NYLON LOCKNUT	8
O	101750	3/8 PLASTIC SHIM WASHER	8
P	101752	3/8 X 3/4" HEX CAP BOLT - BLACK ZINC	2
Q	100909	#10 X 1-1/2" PHILIPS PAN HEAD MOUNTING SCREW	36
R	101873	#10 X 1" PHILIPS PAN HEAD SELF-TAPPING SCREW - BLACK ZINC	38
S	100015	LARGE BLACK DOME CAP	6
T	101510/101075	SHOCK - 75#/500N	2
U	101446-101448	SHOCK - 600N/700N/800N	2
V	101448/102017	SHOCK - 800N/1000N	2
W	101762	RUBBER BUMPER	4
X	101650	#8 X 1-1/4" PHILIPS FLAT HEAD SELF-TAPPING SCREW - BLACK ZINC	4
Y	101552	EAS HANDLE	2
Z	101751	5/16 X 1-1/4" BUTTON HEAD SOCKET BOLT	2
AA	101871	SURE LOCK LATCH ASSEMBLY	2
AB	101065	#8 X 3/4" PHILIPS FLAT HEAD SELF-TAPPING SCREW - BLACK ZINC	8
AC	101078	LOCK	1
AD	101996	#10 X 1" PHILIPS PAN HEAD SELF-DRILLING SCREW - BLACK ZINC	8

CAUTION!

Do not use the Smartop in high wind conditions. Injury from the spa cover being blown over and impacting the spa user can occur.

For additional information on our Smartop product, please visit our website: www.smartopspacover.com