

Step #1

Remove the 1/4 x 3/4" flat head machine screws, 1/4 flat washers and 1/4 nylon locknuts from the back of the ModStep 3 (see Fig. 1). Next, attach the rear rail brackets using the hardware removed and using the same holes (see Fig. 2).

Step #2

Using the supplied #10 x 5/8" self-tapping screws, finish attaching the rear rail brackets to the backside of the ModStep 3 (see Fig. 3).

Step #3

Insert the rail into the rear rail brackets and attach using the supplied 3/8 x 2-3/4" hex cap bolts, 3/8 flat washers and 3/8 nylon locknuts (see Fig. 3).

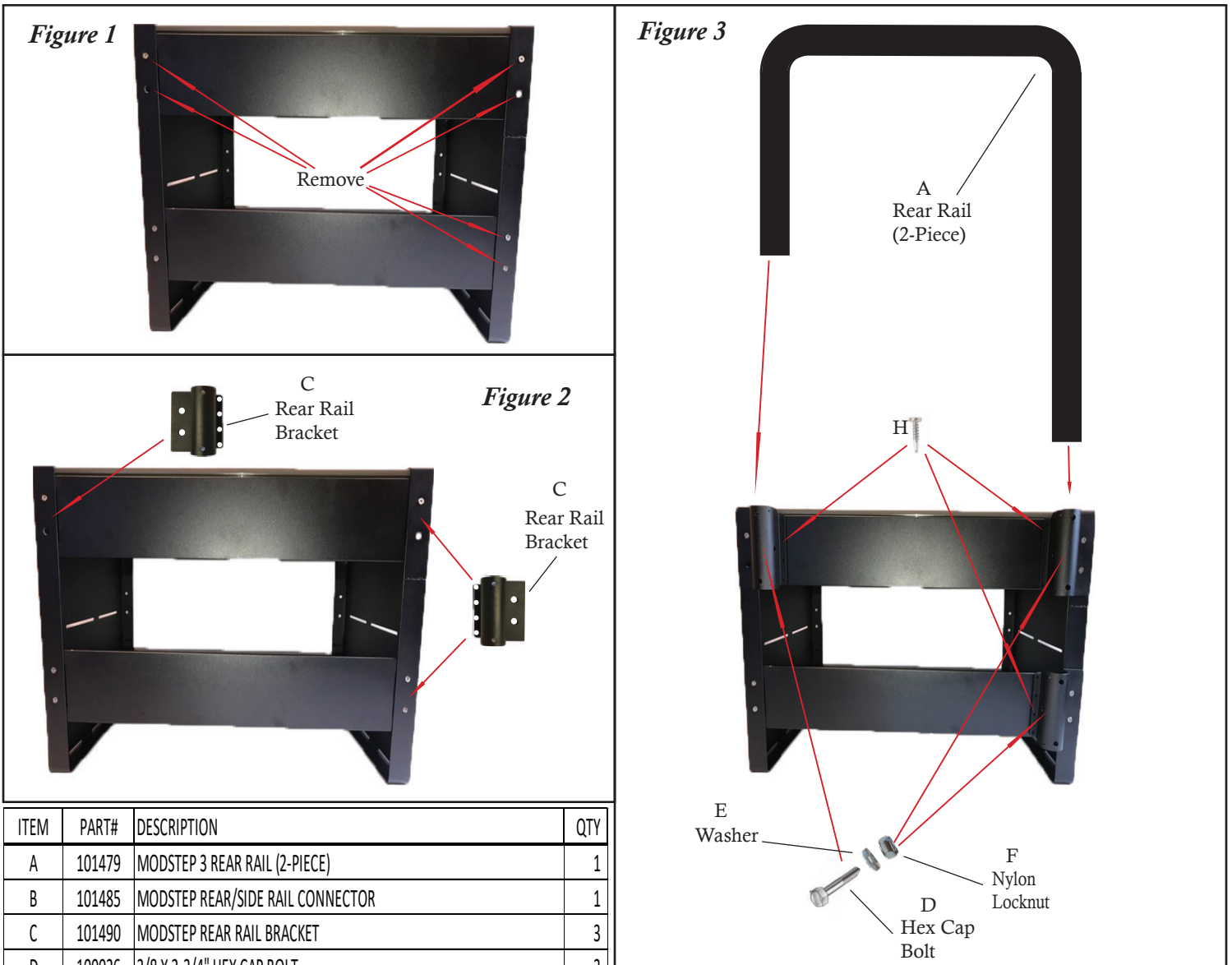

ITEM	PART#	DESCRIPTION	QTY
A	101479	MODSTEP 3 REAR RAIL (2-PIECE)	1
B	101485	MODSTEP REAR/SIDE RAIL CONNECTOR	1
C	101490	MODSTEP REAR RAIL BRACKET	3
D	100026	3/8 X 2-3/4" HEX CAP BOLT	3
E	100012	3/8 FLAT WASHER	3
F	100011	3/8 THIN NYLON LOCKNUT	3
G	100015	LARGE BLACK DOME CAP	6
H	100013	#10 X 5/8" SELF-TAPPING SCREW	24
I	100016	SMALL BLACK DOME CAPS	24