

Sundance® Spas

Easy-to-open cover lift designed specifically for Sundance® 980™ spas, by

Leisure Concepts
The leader in spa accessories

Easy-to-open cover lift CM-III

Installation Instructions - Updated as of 09/06/18

Congratulations on your purchase! This lift was designed to fit seamlessly with the Sundance® Spas 980™ Series models and is engineered for durability and ease of use. Please follow the installation instructions below for proper fit and function.

Figure 1a

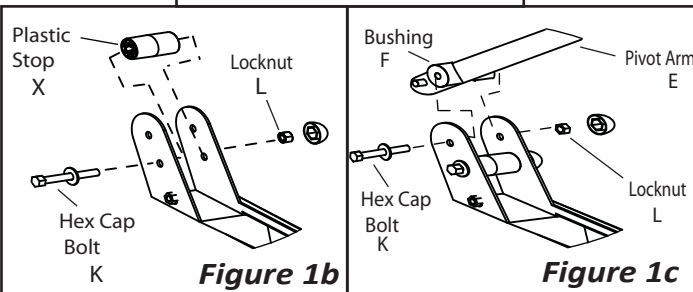
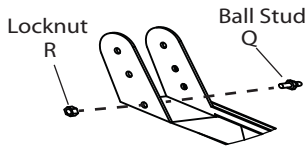

Figure 2

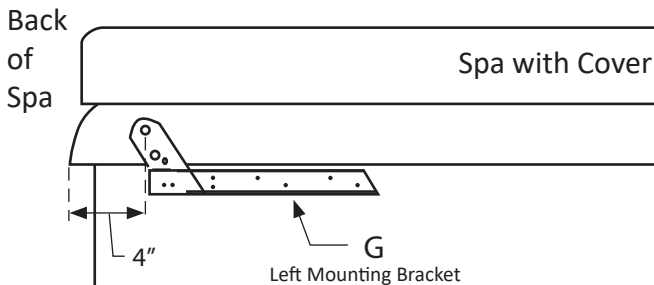
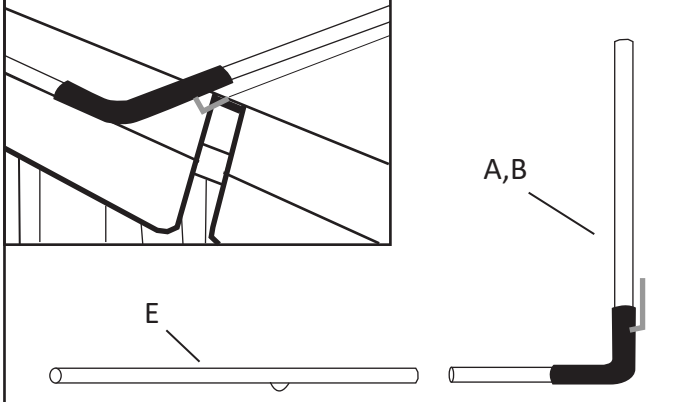

Figure 3



Step #1

Position the spa cover (in closed position) on the spa making sure that all four corners are properly positioned and square on the spa.

Step #2

Install the ball studs on each mounting bracket (see Fig. 1a).

Step #3

Install the plastic stops on each mounting bracket (see Fig. 1b).

Step #4

Using the #10 x 1-1/2" mounting screws, attach the left and right mounting brackets to the appropriate sides of the spa (see Fig. 2). Brackets should be mounted 4" from the back of the spa, directly beneath the lip of the spa (see Fig. 2). **The pivot arm bolt hole in the bracket is measured in from the back of the spa 4".**

Step #5

Starting with the left side first, lay the long end of the support arms on the top of the cover, lying parallel to the spa cover hinge about 1/2" away. Slide the U-shaped retainer clip between the two cover halves with the horizontal part touching the underside of the cover hinge (see Fig. 3). **Note: Do not insert the U-shaped retainer clip in between the seams of the spa cover.** With the left support arm lying on the cover, slide the center coupler piece over the long end of the left support arm. Next, slide the long end of the right support arm into the center coupler and slide the U-shaped retainer clip between the two cover halves.

Step #6

Slide the left and right pivot arms onto the short end of the support arms (see Fig. 3). **Note: Do not insert the self-tapping screws at this time, this will be completed in step #8.** Next, connect the pivot arms to the mounting brackets (see Fig. 1c). Be sure to run the hex cap bolts as pictured. **Note: Lightly tightened the nut so the pivot arm moves freely.**

Step #7

Next, install the ball studs to the left and right pivot arms. Place the two hex dome caps over the ball stud locknuts. **Note: Be sure that the ball is pointing away from the spa (see Fig. 4).**

Step #8

With the center coupler and support arms adjusted properly (about 1/2" away from the cover hinge and centered on the spa), use the #10 X 5/8" self-tapping screws to fasten the support arms to the pivot arms and the center coupler to the support arms (see Fig. 5). **Note: Be sure to rotate the center coupler so that the inserted screws are at a horizontal angle with the screw head facing the back of the spa.**

Step #9

Using the Easy-to-open lift, lift the cover off the spa and place it in the upright position. Snap the gas shocks on to the ball studs. **Note: Be sure to install the gas shocks with the black body on top (see Fig. 6 for complete look).** **Note: you may need to pull back on the pivot arm a small amount to be able to attach the shock to the pivot arm.**

Step #10

Attach the provided 3 hook TowelMate on the preferred side of your Easy-to-open lift by simply snapping it in place and inserting the middle 5/8" self-tapping screw (see Fig. 7).

Step #11

Attach the provided large dome caps to the heads of the bolts used to attach the pivot arms to the mounting brackets in Step 6. Snap the small dome caps on to the exposed heads of the mounting screws and the self-tapping screws.

Operation of the Easy-to-open cover lift CM-III

1. Fold the first half of the spa cover off the spa. Gripping the foam grip, motion the spa cover into its vertical upright position .

CAUTION!

Do not use the coverlift in high wind condition. Injury from the spa cover being blown over and impacting the spa user can occur.

Figure 4

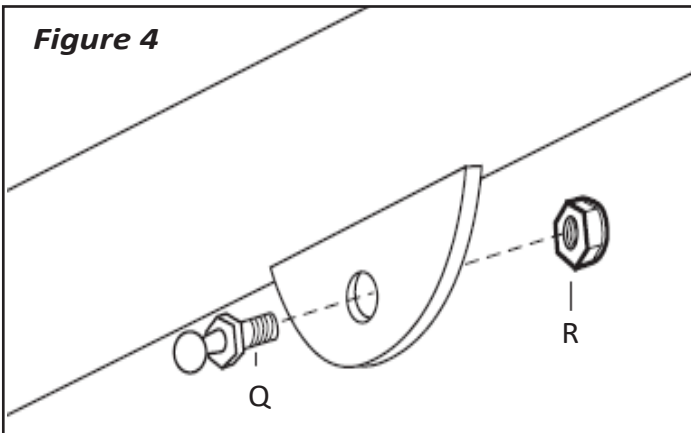

Figure 5

Back of Spa

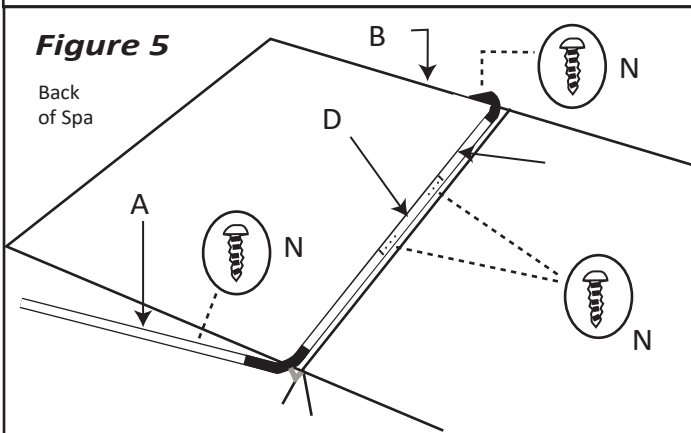

Figure 6

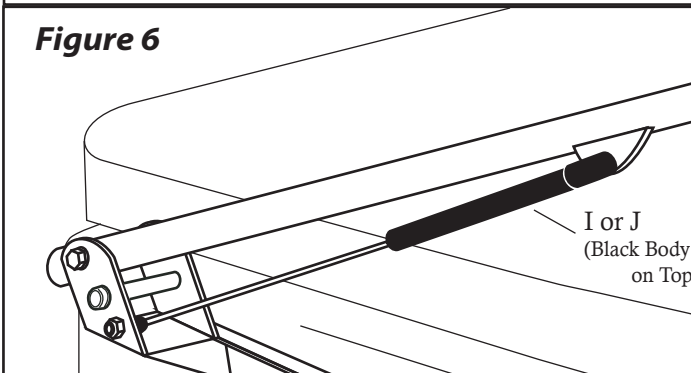
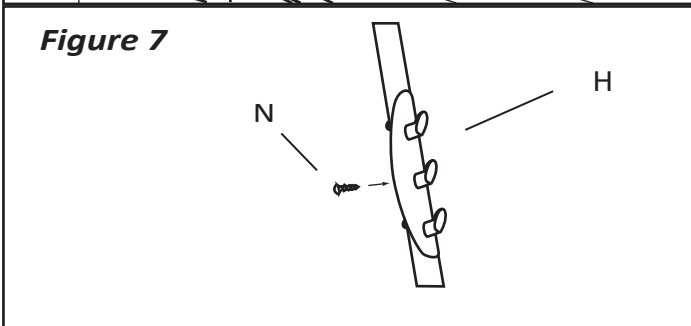

Figure 7



Parts Included in this case

ITEM	PART#	DESCRIPTION	QTY
A	100029	SUPPORT ARM W/RETAINER-LEFT	1
B	100028	SUPPORT ARM W/RETAINER-RIGHT	1
C	100002	FOAM GRIP 8"	2
D	100003	CENTER COUPLER	1
E	100280	EXTENDED PIVOT ARM	2
F	100344	PIVOT BUSHING	4
G(L)	101445	MOUNTING BRACKET-LEFT	1
G(R)	101444	MOUNTING BRACKET-RIGHT	1
H	100008	TOWELMATE	1
I	101632	SHOCK-CMIII LOCKING	1
J	101510	SHOCK-CMIII	1
K	100026	3/8 X 2-3/4" HEX CAP BOLT	4
L	100011	3/8 NYLON LOCKNUT	4
M	100012	3/8 FLAT WASHER	4
N	100013	#10 X 5/8" SELF-TAPPING SCREW	12
O	100909	#10 X 1-1/2" MOUNTING SCREW	14
Q	100244	5/16 BALL STUD	4
R	100032	5/16 NYLON LOCKNUT	4
U	100015	LARGE BLACK DOME CAP	4
V	100034	HEX PLASTIC DOME CAP	4
W	100016	SMALL BLACK DOME CAP	30
X	100033	CMIII PLASTIC STOP	2

Specially manufactured for Sundance® Spas by

Leisure Concepts
The leader in spa accessories